

RETAIL OPPORTUNITY

# WAREHAM

1 Tobey Road, Wareham, MA 02576

MSA Boston

FOR LEASE

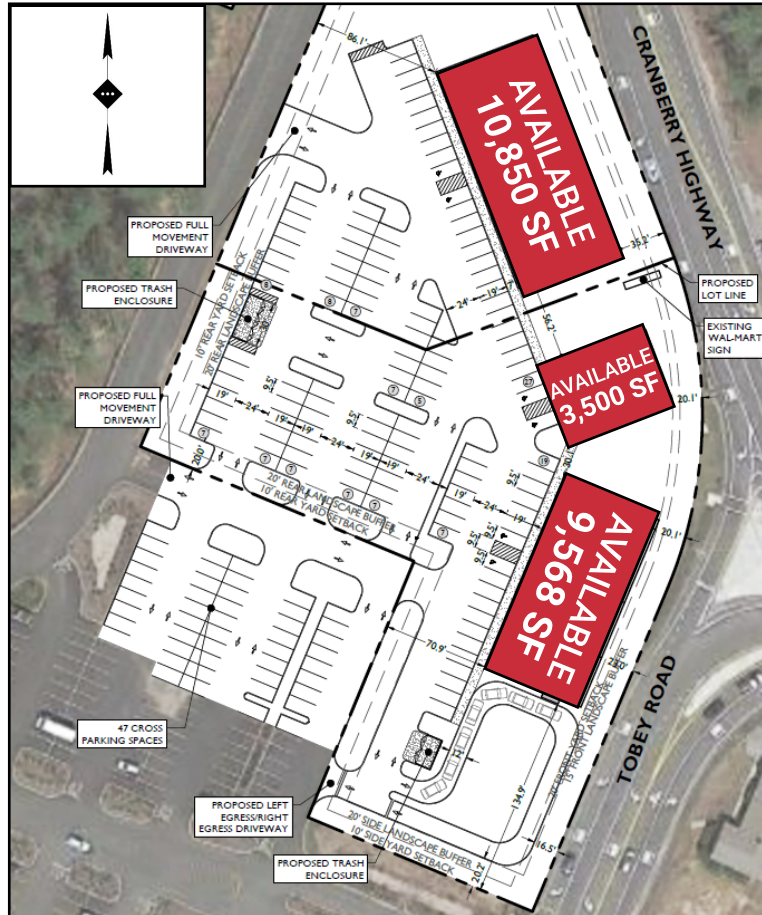

## PROPERTY INFORMATION

DEVELOPMENT COMING IN 2019

- Three proposed new retail developments available, totaling 23,918 SF, anchored by Walmart:
  - **Building A:** Proposed 10,850 SF available
  - **Building B:** Proposed 3,500 SF available
  - **Building C:** Proposed 9,568 SF available with a drive-thru
- Property is located on the corner of Cranberry Highway & Tobey Road near Wareham Crossing, which features retailers such as JCPenney, T.J. Maxx, Michaels, Staples, CVS Pharmacy, Target, L.L. Bean Outlet, & Lowe's Home Improvement
- 0.7 miles North of John William Decas School, which has a population of 645 students
- Retail shop and restaurant opportunities

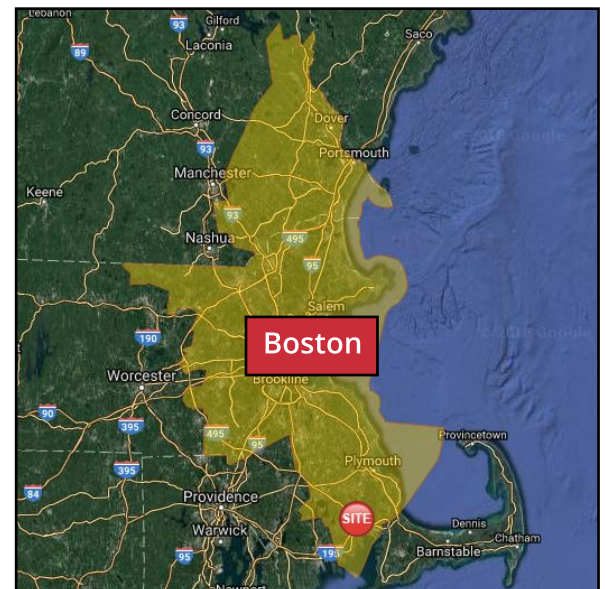

**ALRIG USA**  
DEVELOPMENT

[www.alrigusa.com](http://www.alrigusa.com)

RETAIL OPPORTUNITY

# WAREHAM

1 Tobey Road, Wareham, MA 02576

MSA Boston

FOR LEASE



## MARKET DEMOGRAPHICS

Radius	3-Miles	5-Miles	10-Miles
Population	11,273	25,777	92,950
Average HH Income	\$97,029	\$97,211	\$109,194
Median HH Income	\$74,072	\$77,021	\$85,813
Daytime Employment	8,094	12,603	31,261
Households	4,561	10,228	35,817

Source: SitesUSA 2017 Estimated

## TRAFFIC COUNTS

Cranberry Highway 37,168 VPD

Source: Costar 2017 Estimated

## CONTACT US

**GABE SCHUCHMAN**

Managing Director

(248) 646.9999

gabe@alrigusa.com

**ALRIG USA**

30200 Telegraph Road

Suite 205

Bingham Farms, MI 48025

**THIRD PARTY LEASING**



**ALRIG USA**  
DEVELOPMENT

www.alrigusa.com

© ALRIG USA Inc. This information has been obtained from sources believed reliable. We have not verified it and make no guarantee, warranty or representation about it. Any projections, opinions, assumptions or estimates used are for example only and do not represent the current or future performance of the property. You and your advisors should conduct a careful, independent investigation of the property to determine to your satisfaction the suitability of the property for your needs. Photos herein are the property of their respective owners and use of these images without the express written consent of the owner is prohibited. ALRIG USA and/or its affiliated or related companies in the United States and other countries. All other marks displayed on this document are the property of their respective owners.