

NEW RETAIL DEVELOPMENT ANCHORED BY MEIJER



FOR LEASE

3175 S. Rochester Road / Rochester Hills, MI



RETAIL OPPORTUNITY

NEW RETAIL DEVELOPMENT



Address

3175 S. Rochester Road,
Rochester Hills, MI 48307

Availability

Multi-Tenant Development:

1,612 SF Available + Drive-Thru

1,612 - 4,814 SF Available

Features

- Alrig USA has proposed plans to develop a brand-new multi-tenant retail center consisting of up to 4,814 SF with a drive-thru available for lease.
- Anchored by Meijer, this retail development is located on East Auburn Road and South Rochester Road, near a signalized intersection. The property offers three separate entrances for seamless ingress and egress.
- Nearby retailers include Meijer, Target, Lowe's, Kohl's, Office Max, Culver's, Dollar Tree, Panera, TJ Maxx and many more.
- Restaurant, retail and a drive-thru opportunity are available for lease.
- Pylon signage available.
- Q1 2024 delivery.

Area Tenants



TARGET



Demographics (2022)

	1 MILE	3 MILES	5 MILES
POPULATION	9,163	70,893	203,079
HOUSEHOLDS	3,480	27,559	78,843
AVG HOUSEHOLD INCOME	\$130,130	\$128,516	\$134,248
DAYTIME POPULATION	10,200	73,518	211,739

NEW RETAIL DEVELOPMENT

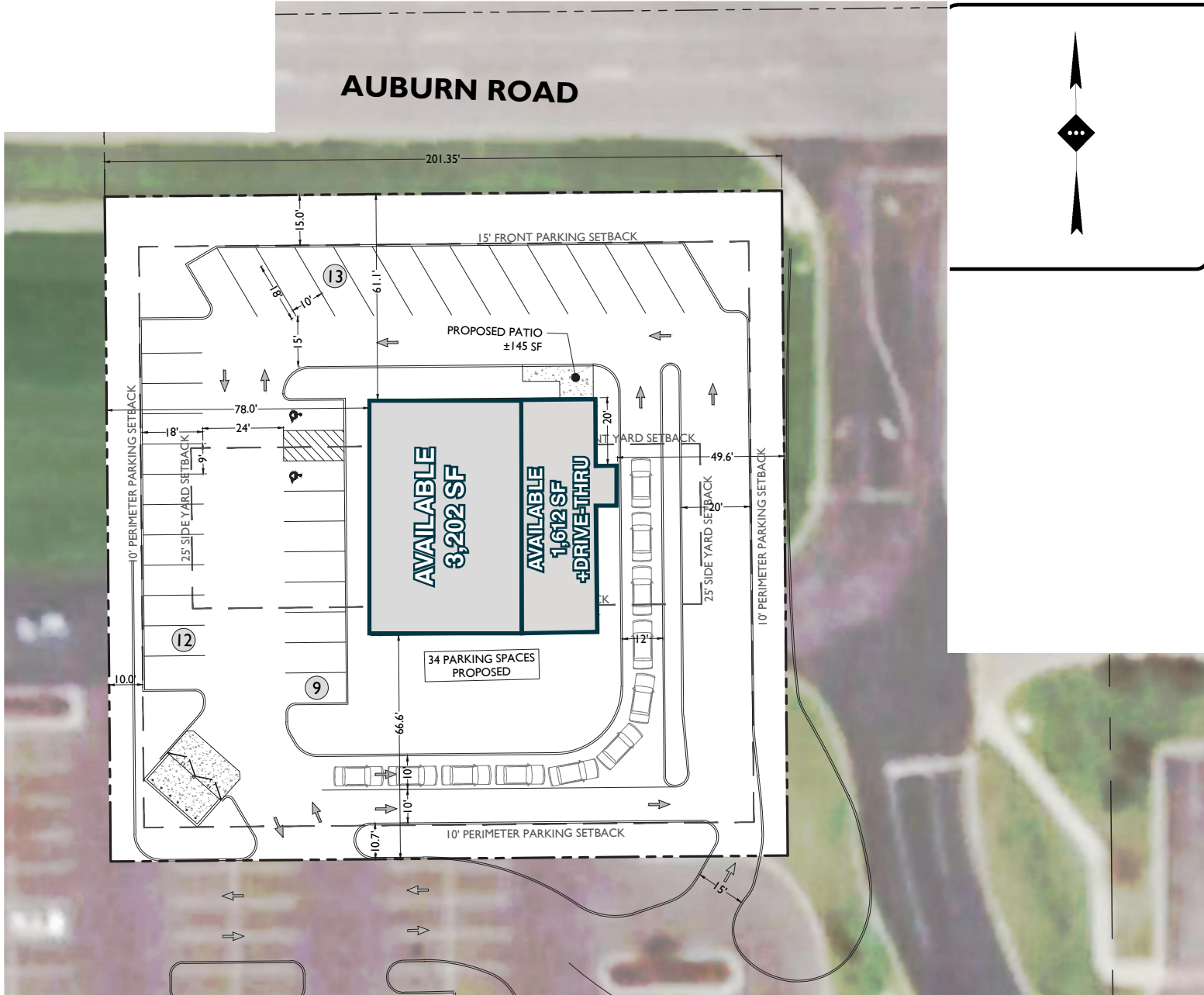

NEW RETAIL DEVELOPMENT



NEW RETAIL DEVELOPMENT



Faith
Fruciano

Mid-America Real Estate -
Michigan, Inc.

T: 248.855.6800

FFruciano@MidAmericaGrp.com

Gabe
Schuchman

Mid-America Real Estate -
Michigan, Inc.

T: 248.855.6800

GSchuchman@MidAmericaGrp.com



38500 Woodward Ave, Suite 100
Bloomfield Hills, Michigan 48304
248.855.6800

MidAmericaGrp.com

Developed By:



CONTACT